



## SLIDE & PRICE CHANGE INSTRUCTIONS FOR THE STRAIGHT SIX



### SLIDE CHANGE

- 1 Remove any actuating bracket attached to the end of the slide.



- 2 Remove slide back-stop and return spring.

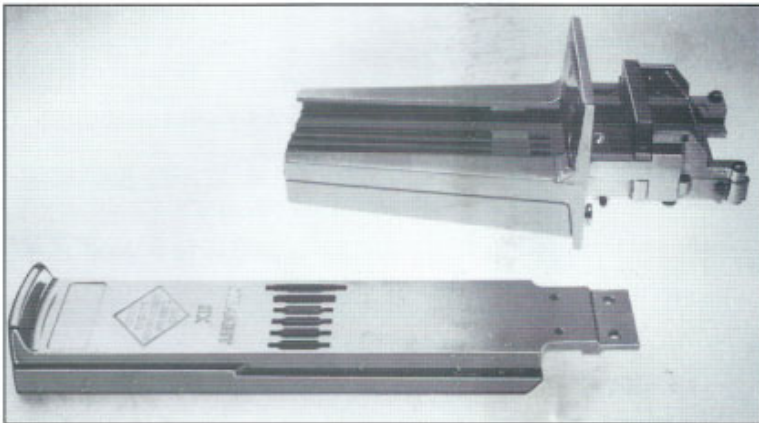

- 3 Pull out slide.

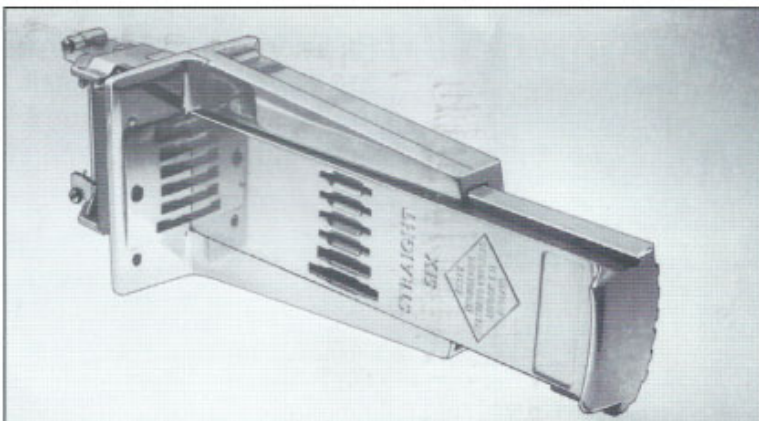

- 4 To enter new slide, turn mech onto its left-hand side and push slide in.

- 5 Replace slide stop and return spring. Remember to use LOCTITE on slide stop screws.

## PRICE CHANGE

Carry out operations 1-3 of slide change then

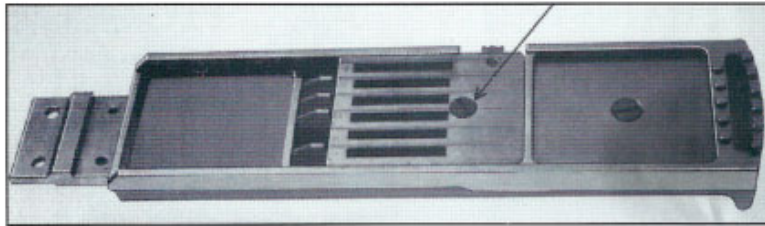

- 6 Undo stop plate screw.  
Use a LARGE screwdriver.

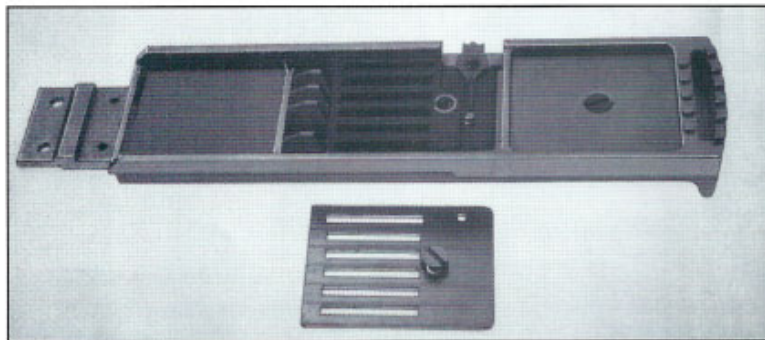

- 7 Take off stop plate.

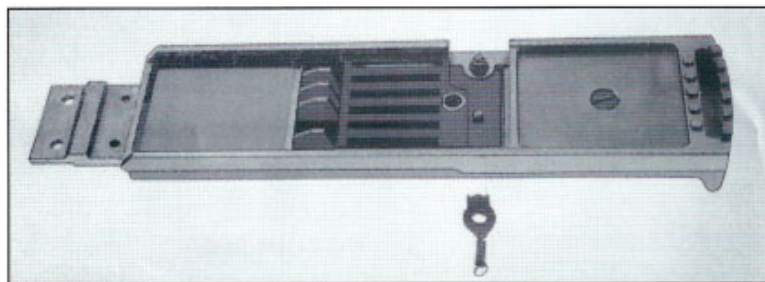

- 8 Remove ratchet pawl  
and spring

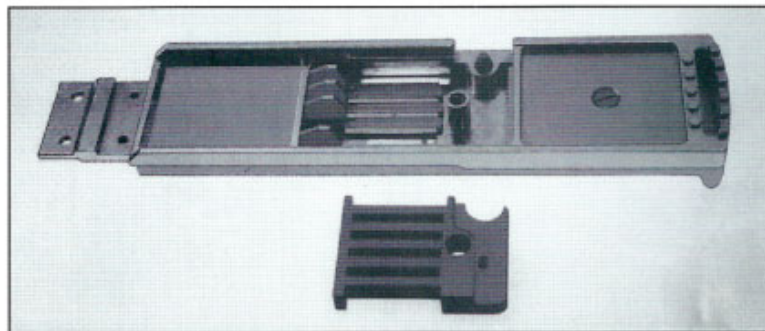

- 9 Remove nylon moulding.

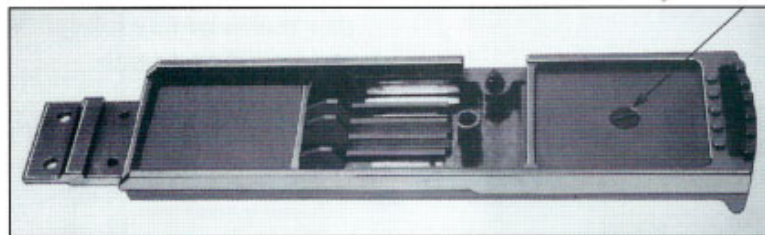

- 10 Re-arrange block out cams  
to suit your new price, tak-  
ing additional cams from  
under cover plate.

11 Replace cover plate LOCTITE screw.

12 Replace moulding.

13 Replace ratchet spring and ratchet pawl.

*NOTE: Ratchet pawl goes with swaged side up.*



Swaged side



Plain side

take care not to strain ratchet spring.

14 Replace stop plate. LOCTITE SCREW.

15

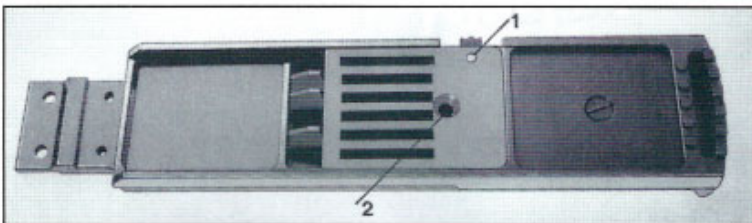

Make sure stop plate (1) locates the ratchet pivot, before replacing screw in countersunk hole (2).

16 MAKE CERTAIN LOCTITE is used to hold stop plate fixing screw vibration proof.

17 Follow 4 and 5 of slide change instructions on page 1.

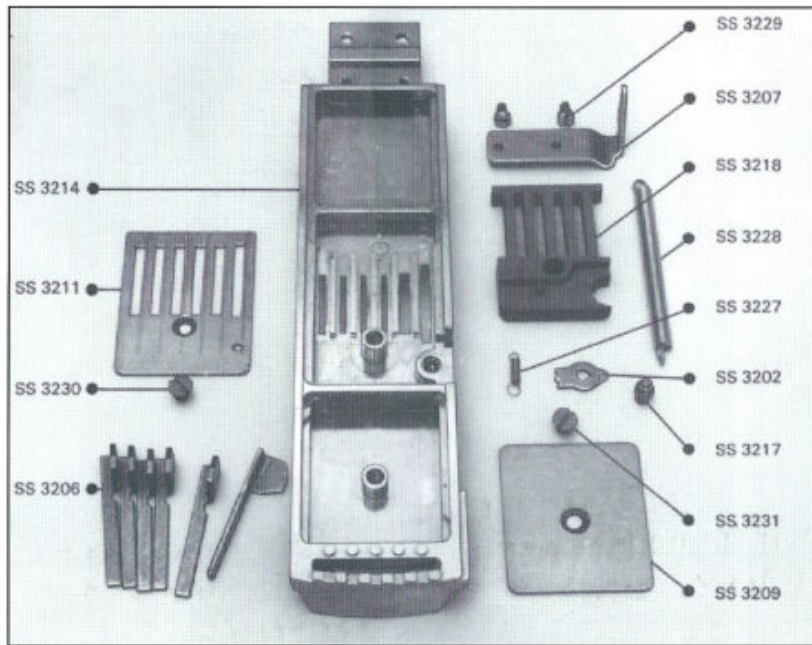

**FIG. 1**

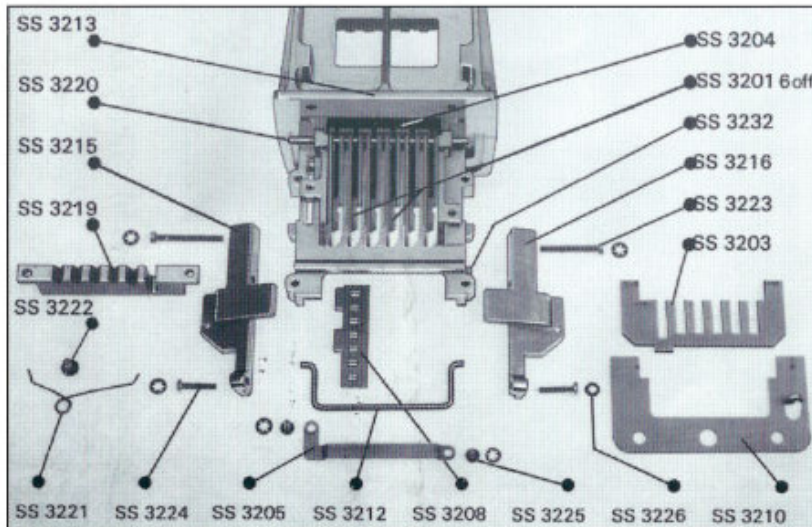

**FIG. 2**

**FOR ORDERING SPARES**

**PART LIST FOR STRAIGHT SIX**

	<b>Part No.</b>
Under Pawl (6 Per Mechanism) (Fig. 2)	SS3201
Special Cast Pawl (Not Shown)	SS3201A
Ratchet Pawl (Fig. 1)	SS3202
Coin Gate (Fig. 2)	SS3203
Under Pawl Spring (Fig. 2)	SS3204
Under Pawl Stop (Fig. 2)	SS3205
Coin Slot Blank (Fig. 1)	SS3206
Slide Stop (Fig. 1)	SS3207
Rack (Fig. 2)	SS3208
Cover Plate (Fig. 1)	SS3209
Gate Cover Plate (Fig. 2)	SS3210
Stop Plate (Fig. 1)	SS3211
Non Return Bar (Fig. 2)	SS3212
Casting Body (Fig. 2)	SS3213
Slide (Fig. 1)	SS3214
L/H Side Rail (Fig. 2)	SS3215
R/H Side Rail (Fig. 2)	SS3216
Ratchet Peg (Fig. 1)	SS3217
Coin Cage (Fig. 1)	SS3218
Coin Selector Bridge (Fig. 2)	SS3219
Under Pawl Rod (Fig. 2)	SS3220
Spring Operating Non Return Bar (Fig. 2)	SS3221
6 <sup>BA</sup> Shoulder Screw Fixing 3221 (Fig. 2)	SS3222
Screw 6 <sup>BA</sup> x 1/2" Pan HD Fixing L/H Rail (Fig. 2)	SS3224A
Screw 6 <sup>BA</sup> x 5/16" Pan HD Fixing R/H Rail (Not Shown)	SS3224B
Screw 6 <sup>BA</sup> x 3/16" Pan HD Fixing Under Pawl Stop (Fig. 2)	SS3225
6 <sup>BA</sup> Shakeproof Washer (Fig. 2)	SS3226
Ratchet Spring (Fig. 1)	SS3227
Return Spring (Fig. 1)	SS3228
Screw 4 <sup>BA</sup> x 1/2" CH HD Fixing Slide Stop (Fig. 1)	SS3229
Screw 2 <sup>BA</sup> x 1/4" CSK Fixing Stop Plate (Fig. 1)	SS3230
Screw 4 <sup>BA</sup> x 3/16" CH HD Fixing Cover Plate (Fig. 1)	SS3231
Screw Plastic M4 x 6mm Grub Screw (Fig. 2)	SS3232
Screw 6 <sup>BA</sup> x 1 1/8" CH HD Fixing Laser Support (Fig. 2 Unmarked)	SS3233
Bridge Bias Spring (Not Shown)	SS3234
Full Nut 6 <sup>BA</sup> Locking Bridge Fixing Screws (Not Shown)	SS3235
Selector Bridge Cover (Not Shown)	SS3236
Slide Support (Not Shown)	SS3237
Secondary Under Pawl Spring (Not Shown)	SS3238
Slide Stop Buffer (Not Shown)	SS3239
4 <sup>BA</sup> Full Nut Locking Slide Stop (Not Shown)	SS3240
Screw 6 <sup>BA</sup> x 3/16" Pan HD Fixing Laser Blank (Not Shown)	SS3241
Screw 6 <sup>BA</sup> x 1/8" CSK Fixing Bridge Cover (Not Shown)	SS3242
Backing Plate Screw (Not Shown)	SS3243
Laser Cut Selector Blank (Not Shown)	SS3244
Under Pawl Buffer (Not Shown)	SS3245
Screw 4 <sup>BA</sup> x 7/16" CSK Fixing Slide Stop (Not Shown)	SS3246
Screw 6 <sup>BA</sup> x 1/4" CH HD Fixing Under Pawl Stop (Not Shown)	SS3247
6 <sup>BA</sup> Single Coil Spring Washer for SS3238 (Not Shown)	SS3248



**ESSEX ENGINEERING WORKS (WANSTEAD) LTD.**

12 NELSON ROAD, WANSTEAD, LONDON E11 2AX

TELEPHONE: 020 8989 2833/2012 FAX: 020 8530 1117